



St. Paul county encourages everyone to keep their municipal address signs posted. The sign will make it easier for visitors to locate your property, but more importantly, it will help emergency crews find you more quickly in case of emergency.

Covering an area of 3297.74 square kilometers, St. Paul County emergency crews strive to respond to 9-1-1 calls in the most effective and timely manner possible. A crew is likely to find the exact site more quickly if there is a municipal address sign to provide additional direction.

Know your municipal address...

Though keeping your municipal address sign posted is important, all county residents should know their municipal address. It is a good idea to write your address down and place it near the phone, so it is readily available in case someone in your household must report an emergency on your property.

Every moment counts...

CONTACT US

COUNTY OF ST. PAUL NO

MAIN OFFICE
5015-49 AVE
ST. PAUL, AB

Phone: 780-645-3301
Fax: 780-645-3104

COUNTY OF ST. PAUL NO. 19

MUNICIPAL ADDRESSING SYSTEM

Help us find you more *quickly* in an emergency.



What is the municipal addressing system?

Modeled after the address system found in most major cities, the municipal addressing system is widely used by rural municipalities throughout Alberta. In the county each property is designated a municipal address that relates the range road, township road or named road from which the property's driveway is built.

For properties outside of multi-parcel subdivisions:

- Addresses are referenced off of the range roads, township roads or named roads.
- Address numbers increase going North and West.
- Even address numbers are on the North and West side of the roads and odd addresses are on the South and East side.

For properties in multi-parcel subdivisions:

- Addresses are referenced from where the internal subdivision road comes off of the range road or township road (if the subdivision has more than one entrance, one entrance is arbitrarily chosen as being the address identifier).
- Lots are assigned a number in a clockwise direction wherever possible.

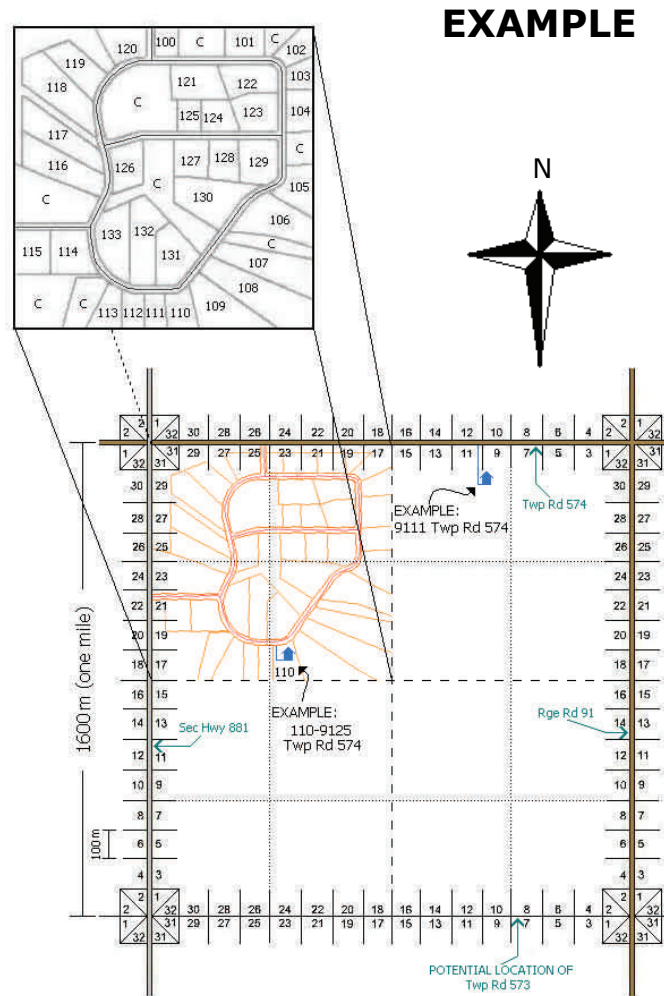

EXAMPLE

IN REFERENCE TO EXAMPLE

Example: 9111 Twp Rd 574

The access location (approach) is on Twp Rd 574, and 91 is the intersecting Rge Rd number to the East. 11 is the address number on the south side of Twp Rd 574.

Example: 110-9125 Twp Rd 574

Subdivision addresses are based on the location of the subdivision road with a township road, range road, or highway. Subdivision lots are treated as multiple addresses having the same access location (approach).

Subdivision lot sign (three or more digits):



Complete municipal address sign:



PLEASE NOTE:

Signs will not be installed until Alberta One-Call has located all potential active underground lines.

This process will be completed approximately within the next year.

- Each mile of township road, range road and highway is divided in 16 intervals.
- Each mile of township road, range road and highway has 32 addresses.
- Each interval is approximately 100m.
- Standard abbreviations:
 - Rge Rd= Range Road
 - Twp Rd= Township Road
 - Sec Hwy= Secondary Highway
 - Hwy= Primary Highway