

BYLAW 634/06

TOWN OF ELK POINT #043

---

**A Bylaw of the Municipality of the Town of Elk Point, in the Province of Alberta, to amend the Land Use Bylaw, Bylaw No. 622/03.**

---

WHEREAS the Municipal Government Act, R.S.A. ("the Act") authorizes the Council to establish and amend a Land Use Bylaw;

NOW THEREFORE, the Council of the Town of Elk Point in the Province of Alberta, duly assembled, hereby enacts as follows:

1. The Land Use Bylaw of the Town of Elk Point, Bylaw 622/03, is hereby amended as follows:
  - a. Schedule A, the Land Use District Map, is hereby amended by changing the designation of that portion of SE 1/4 - 12 - 57 - 7 W4th as indicated on Schedule "A" attached hereto, from Urban Reserve (UR) District and Direct Control (DC) District to Single Detached Residential (R1) District.

**1ST READING** READ a **FIRST** time in Council this 20<sup>th</sup> day of February, A.D., 2006.

**2ND READING** READ a **SECOND** time in Council this 20<sup>th</sup> day of February, A.D., 2006.

**UNANIMOUS CONSENT** for **THIRD** reading this 20<sup>th</sup> Day of February, 2006.  
Resolution #06- 15

**3RD AND FINAL READING** READ a **THIRD** time in Council and **FINALLY PASSED** this 20<sup>th</sup> day of February, A.D., 2006.

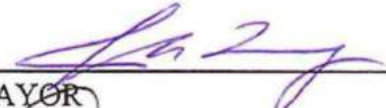
  
\_\_\_\_\_  
MAYOR

  
\_\_\_\_\_  
TOWN MANAGER

BYLAW 634/06  
SCHEDULE A

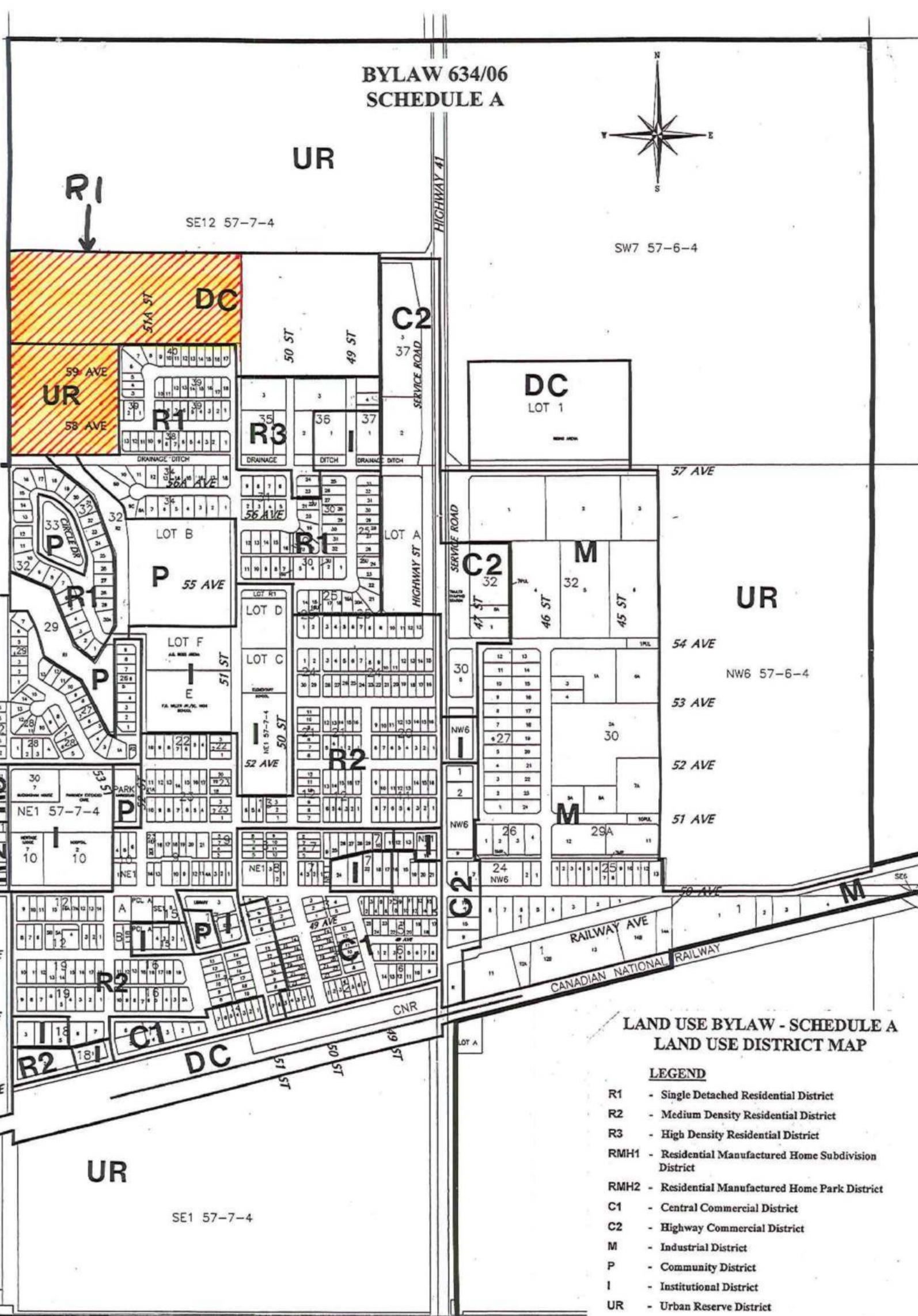
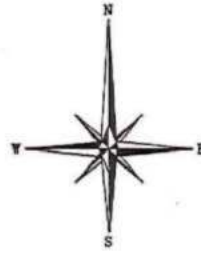

LAND USE BYLAW - SCHEDULE A  
LAND USE DISTRICT MAP

LEGEND

- R1 - Single Detached Residential District
- R2 - Medium Density Residential District
- R3 - High Density Residential District
- RMH1 - Residential Manufactured Home Subdivision District
- RMH2 - Residential Manufactured Home Park District
- C1 - Central Commercial District
- C2 - Highway Commercial District
- M - Industrial District
- P - Community District
- I - Institutional District
- UR - Urban Reserve District
- DC - Direct Control District