

MAP 2

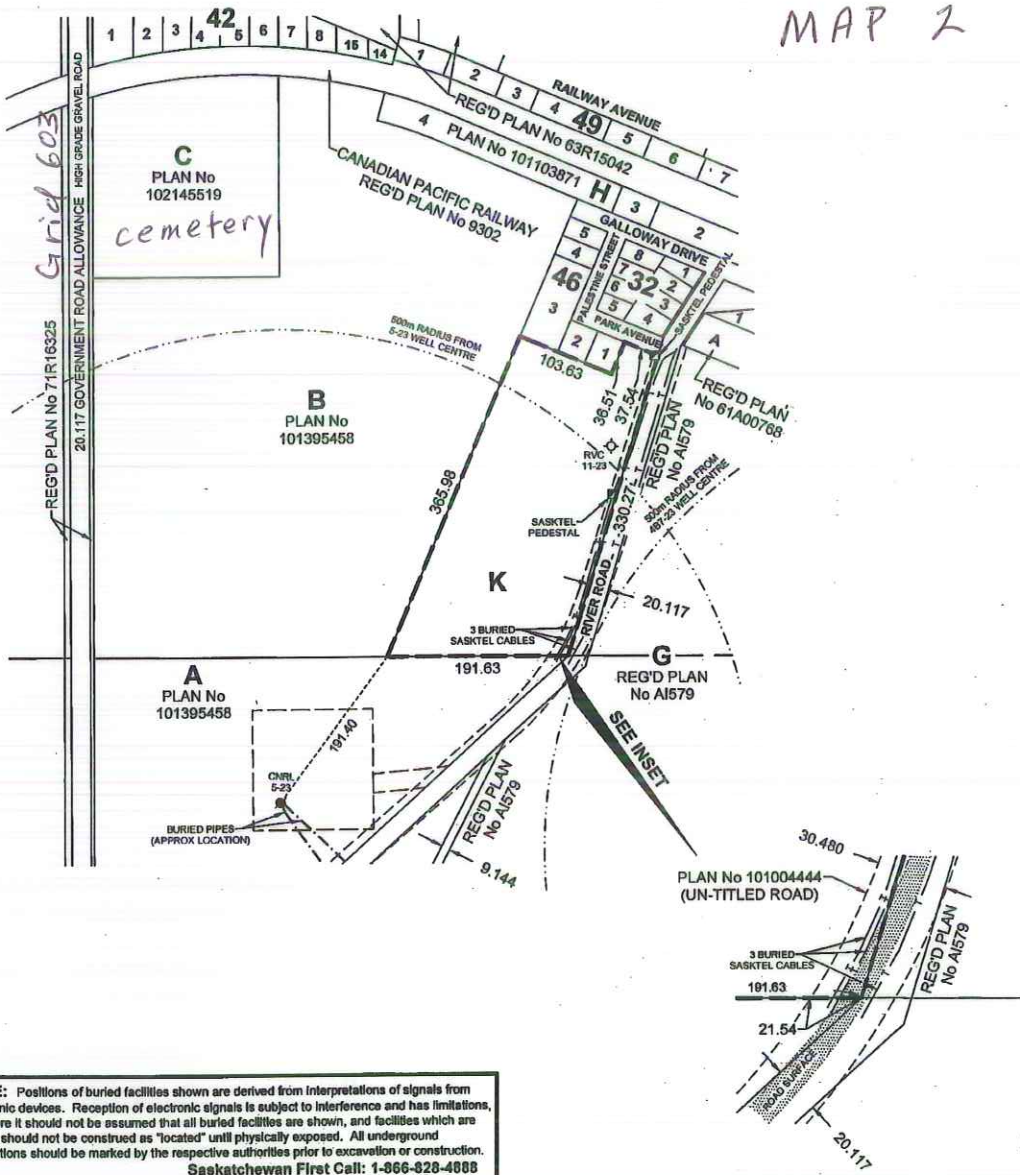

NOTE: Positions of buried facilities shown are derived from interpretations of signals from electronic devices. Reception of electronic signals is subject to interference and has limitations, therefore it should not be assumed that all buried facilities are shown, and facilities which are shown should not be construed as "located" until physically exposed. All underground installations should be marked by the respective authorities prior to excavation or construction.
Saskatchewan First Call: 1-866-828-4888

PLAN OF PROPOSED SUBDIVISION
OF PART OF
PARCEL B, PLAN NO. 101395458
NW 1/4, SEC 23, TWP 3, RGE 2, W 2 Mer
OXBOW, SASKATCHEWAN
BY: T. W. LUDDINGTON, SLS
2016
SCALE: 1:5000

DISTANCES ARE IN METRES AND DECIMALS THEREOF.
DISTANCES ARE APPROXIMATE AND MAY VARY BY +/- 1.0m.
AREA REFERRED TO IS OUTLINED BY A BOLD DASHED LINE AND CONTAINS:

PARCEL K = 6.50 ha. (13.68 ac.)

CERTIFIED CORRECT THIS 7TH DAY OF JANUARY, 2016.

T. W. Luddington
SASKATCHEWAN LAND SURVEYOR
PREPARED BY MIDWEST SURVEYS INC.



OWNERS:
Dan Sifton
Dan Sifton

