

**County of Wetaskiwin
Land Use Districts**

- IN Industrial
- UF Urban Fringe
- Ag Agriculture
- CR County Residential
- TS Transfer Station
- ILF Inactive Land Fill

**Town of Millet
Land Use Bylaw**

REVISED: JANUARY, 2017

Explanation of symbols

- R1 - Single Detached Dwelling Residential District
- R1A - Residential Redevelopment District
- R2A - Residential Zero Lot Line District
- RMP - Manufactured Home Park District
- R2 - Low Density Residential District Regulations
- R3 - Medium Density Residential District Regulations
- R4 - High Density Residential District Regulations
- C1 - Downtown Commercial District Regulations
- M - Industrial District Regulations
- US - Urban Service and Open Space Regulations
- UX - Urban Expansion District
- DC - Direct Control District

All utility lots, walkways, and buffer strips are classified as Urban Service, although the roads and lanes are not classified even if they appear to be included in a district on this map

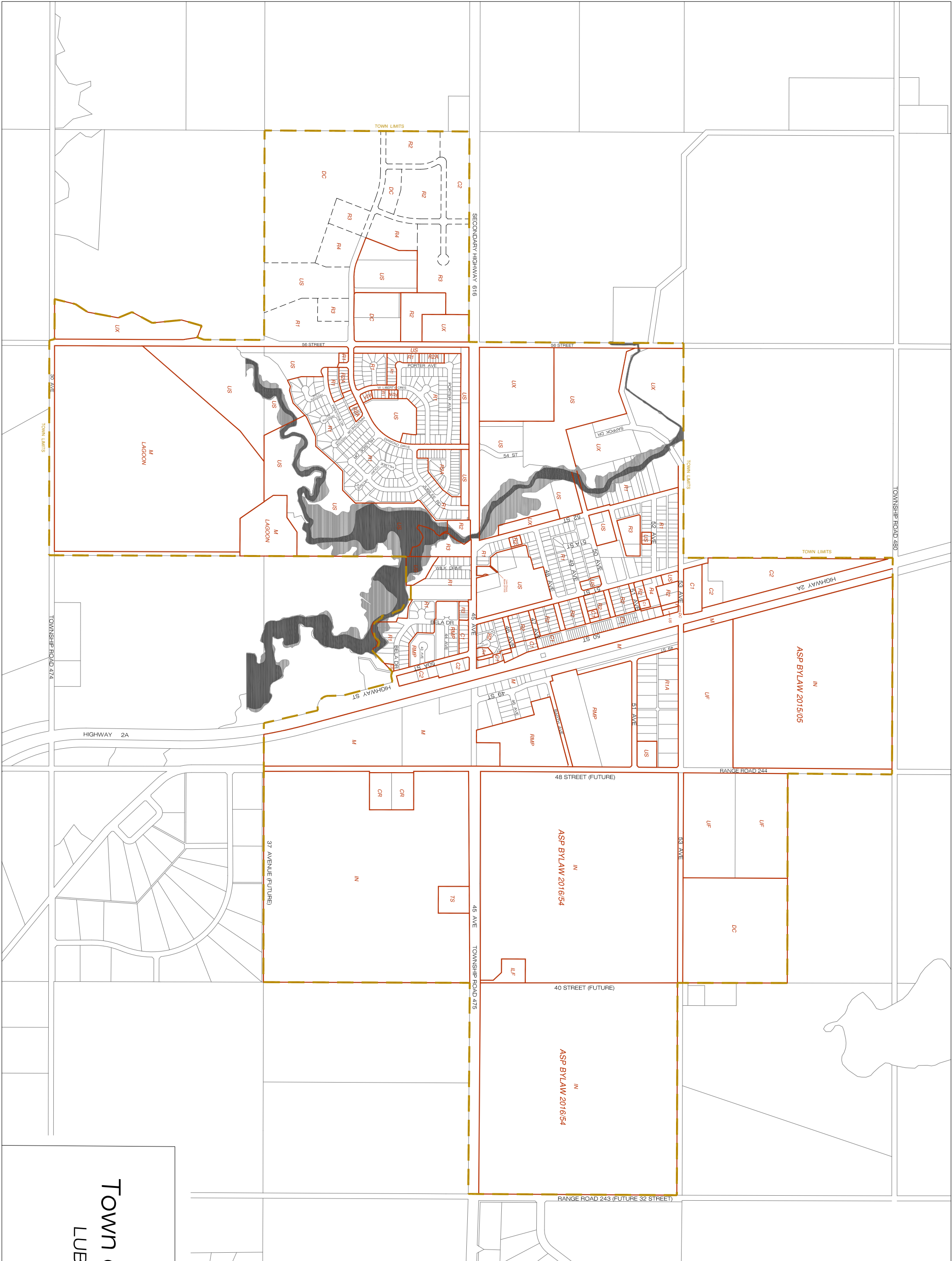

**Town of Millet
LUB Map**

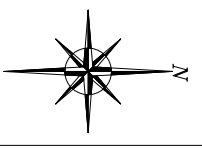

REVISED: MARCH, 2018